

AUTOMATIC NEEDLE THREADER (MODELS 3005 + 3007)

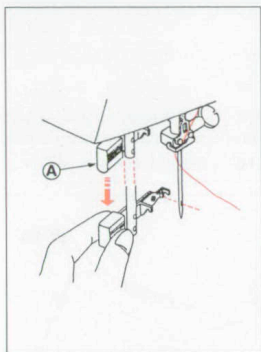

(Model 3005): Turn the balance wheel towards you to raise the needle to the highest position. Pull 15 cm (6") of thread.

(Model 3007): By pressing the up/down needle position key, raise the needle to its highest position. Pull 15 cm (6") of thread. Pull the automatic needle threader down as far as it will go.

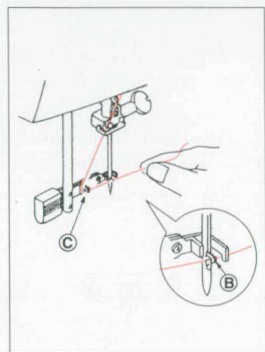

Turn the knob **A** in the direction of the arrow in the illustration, then insert the hook **B** into the needle eye. Lead the thread around the guide **C** and under the hook **B**.

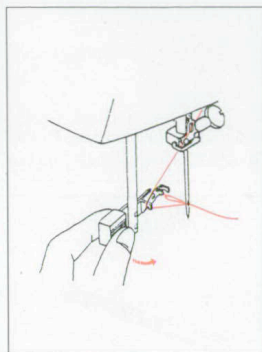

Turn the knob **A** in the direction of the arrow in the illustration, then draw the thread loop to the back of the needle.

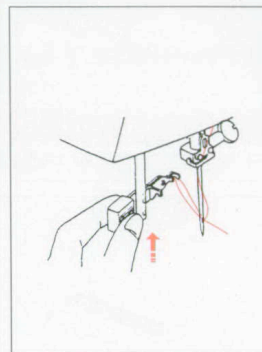

Raise the needle threader knob **A** slowly to draw the thread loop up.

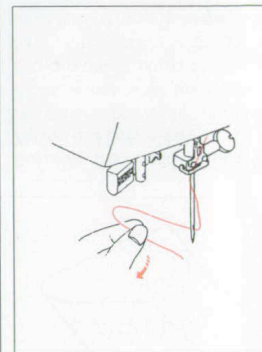

Pass the end of the thread through the needle eye by pulling the thread loop to the back.

* The needle threader can be used with needles No. 11/75, 12/80, 14/90, 16/100 and needles with blue shank.